



TYPE E6 MAIN VALVE

# TYPE E6 MAIN VALVE

## HIGH PRESSURE-HIGH LIFT COLD SERVICE

SIZES 3/4" – 12"  
PRESSURES to 250 PSIG at 200°F

- Normally Closed
- Single Seat
- Balanced Hycar Diaphragm
- Protected Main Spring
- Composition Disc for Tight Shutoff
- Air & Gas Applications
- Accurate Regulation Unaffected by Service Conditions
- ANSI/FCI 70-2 Class VI Shutoff
- Virtually Frictionless for Long Service Life
- Packless Construction
- Easy In-line Maintenance
- Wide Variety of Pilots for Many Applications

### APPLICATION DATA

- Pressure Regulating for Compressed Air Distribution
- Pressure Regulating for Gas Service
- Maintain Back Pressure or Differential Pressure
- For use with Self-contained, Pneumatic or Electronic Pilots
- Single Point or Multiple Use Applications
- Slow Start-up or Shutdown

### VALVE RATINGS

Valve Ends ASME/ANSI	Pressure PSIG (bar)	Temperature °F (°C)
-------------------------	------------------------	------------------------

#### CAST IRON

B16.4 Class 250 NPT	250 (17.2)	@ 200 (93)
B16.1 Class 125 Flanged	125 (8.6)	@ 200 (93)

Other pressure/temperature ratings available; consult factory.

Canadian Registration # OC 0591.9C

*Installation Tip:* Add EZ Connections for ease of maintenance  
SEE PAGE 42

SIZING INFO  
PAGE 108

### OPTIONS *See page 42*

- Dashpot for Water Service
- Integral Mount Pilot
- Insulcap Insulating Jacket
- Balanced Construction
- EZ Connections

### TYPICAL CONFIGURATIONS

PRESSURE REDUCING	.....TYPE E6D
AIR ADJUSTED	.....TYPE E6A
BACK PRESSURE	.....TYPE E6Q
PUMP GOVERNOR	.....TYPE E6P
LOAD ALLOCATING	.....TYPE E6FD
AIR CONTROLLED	.....TYPE E6AP60
ELECTRONIC SLOW START	.....TYPE E6D208D
SOLENOID CONTROLLED	.....TYPE E6MD
SOLENOID ACTUATED	.....TYPE E6M
DIFFERENTIAL	.....TYPE E6N
TEMPERATURE CONTROL	.....TYPE E6T

### RATED FLOW COEFFICIENTS (Cv)

SEAT FACTOR	REGULATOR SIZE												
	3/4	1	1 1/4	1 1/2	2	2 1/2	3	4	5	6	8	10	12
Full	7.6	11.7	18.9	27.4	43	67	95	159	258	350	665	1018	1611
Normal	5.7	10.0	13.4	19.8	25	35	59	120	176	228	366	525	952

# TYPE E6 MAIN VALVE

## SPECIFICATION

The valve shall be self-operated, external pilot type, single seated, composition disc, hycar diaphragm actuated, normally closed design. The valve will function quickly and shut tight on dead end service. Seats and stems shall be of stainless steel. There shall be no springs in the flow space and no stuffing box. The valve shall be easy to maintain with all parts accessible without removal from the line.

## MATERIALS OF CONSTRUCTION

Body, Cast Iron .....ASTM A126 Cl. B  
 Body, Cast Bronze .....ASTM B61 UNS C92200  
 Stem .....303 St. Stl. ASTM A582  
 Disc .....Hycar Comp.  
 Seat 3/4 - 5" .....420 St. Stl. ASTM 473 CA-40  
 Seat 6 - 8" .....316 St. Stl. ASTM A743 CF-8M  
 Gasket .....Non-asbestos  
 Diaphragm .....Hycar  
 Spring .....Steel  
 Disc Holder .....ASTM B16 UNS C36000

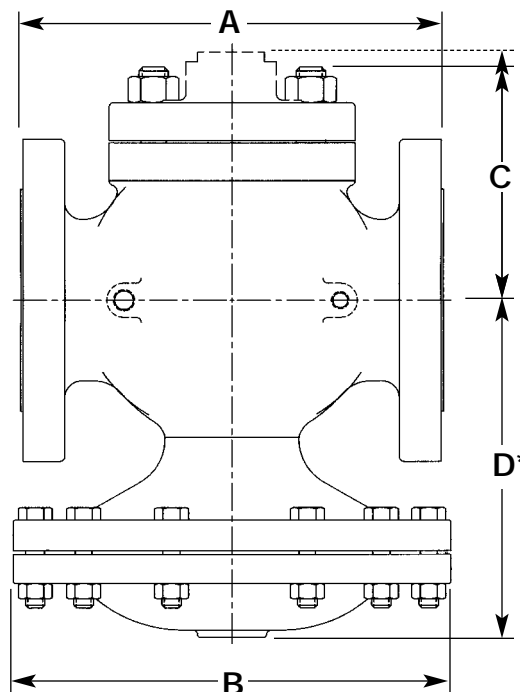

TYPE E6  
MAIN VALVE

TYPE E6 MAIN VALVE

FITTINGS ON  
PAGE 46

## DIMENSIONS inches (mm) AND WEIGHTS pounds (kg)

SIZE	DIMENSIONS							APPROX. WT.		
	A			B	C		D*	ANSI NPT	ANSI 125	ANSI 250
	ANSI NPT	ANSI 125	ANSI 250		Std. Mount	Integral Mount				
3/4 (19)	4 3/4 (111)	—	—	6 7/8 (175)	2 7/8 (73)	3 5/8 (92)	6 3/8 (162)	18 (8)	—	—
1 (25)	5 3/8 (137)	5 1/2 (140)	6 (152)	6 7/8 (175)	3 5/8 (92)	4 3/8 (111)	6 5/8 (168)	18 (8)	27 (129)	30 (14)
1 1/4 (32)	6 1/2 (165)	6 3/4 (171)	7 1/4 (184)	9 1/8 (232)	4 1/8 (105)	4 (102)	7 3/4 (197)	37 (17)	39 (18)	44 (20)
1 1/2 (38)	7 1/4 (184)	6 7/8 (175)	7 3/8 (187)	9 1/8 (232)	4 3/8 (111)	4 1/2 (114)	7 7/8 (200)	42 (19)	50 (23)	56 (25)
2 (51)	7 1/2 (191)	8 1/2 (216)	9 (229)	11 1/8 (283)	5 1/4 (133)	5 (127)	8 5/8 (219)	66 (30)	73 (33)	81 (37)
2 1/2 (64)	—	9 3/8 (238)	10 (254)	11 1/8 (283)	5 3/4 (146)	5 3/8 (137)	9 (229)	—	83 (38)	95 (43)
3 (76)	—	10 (254)	10 3/4 (273)	13 1/2 (343)	6 5/8 (168)	6 3/8 (162)	9 7/8 (251)	—	124 (56)	146 (66)
4 (102)	—	11 7/8 (302)	12 1/2 (318)	13 1/2 (343)	7 5/8 (194)	6 5/8 (168)	12 3/4 (324)	—	206 (94)	234 (106)
5 (127)	—	13 3/8 (346)	14 1/2 (368)	13 1/2 (343)	8 1/2 (216)	7 3/8 (187)	13 1/4 (337)	—	275 (125)	287 (130)
6 (152)	—	15 1/8 (384)	16 (406)	16 3/4 (425)	10 (254)	7 (178)	15 1/2 (394)	—	363 (165)	431 (196)
8 (203)	—	19 (483)	20 (508)	16 3/4 (425)	11 1/2 (292)	9 1/4 (235)	17 5/8 (448)	—	508 (231)	610 (277)

\*Add 100% to D dimension for stem removal clearance.